

Operator safety and ease of manipulation, that's what you get with CON-V-AIR SOLUTIONS' bulk bag unloader. With its standard 2-metric-ton reinforced steel structure, heavy duty bag support sealing membrane and intermediate hopper, complete with toolless opening mechanism, the BBU-FL model bulk bag unloader allows the operator to safely and easily load a bulk bag into place using a forklift.

BBU-FL System Features

- Painted reinforced steel structure
- Bolted assembly adjustable in height
- Heavy duty bag support sealing membrane
- Access door with toolless opening mechanism
- Bag lifting frame
- Electric vibrator

BBU-FL Optional System Features

- Spout-lock system
- Load cell mounting
- Pneumatic bag conditioning system
- Dust collection system
- Stainless steel contact parts



BBU-FL Model Shown

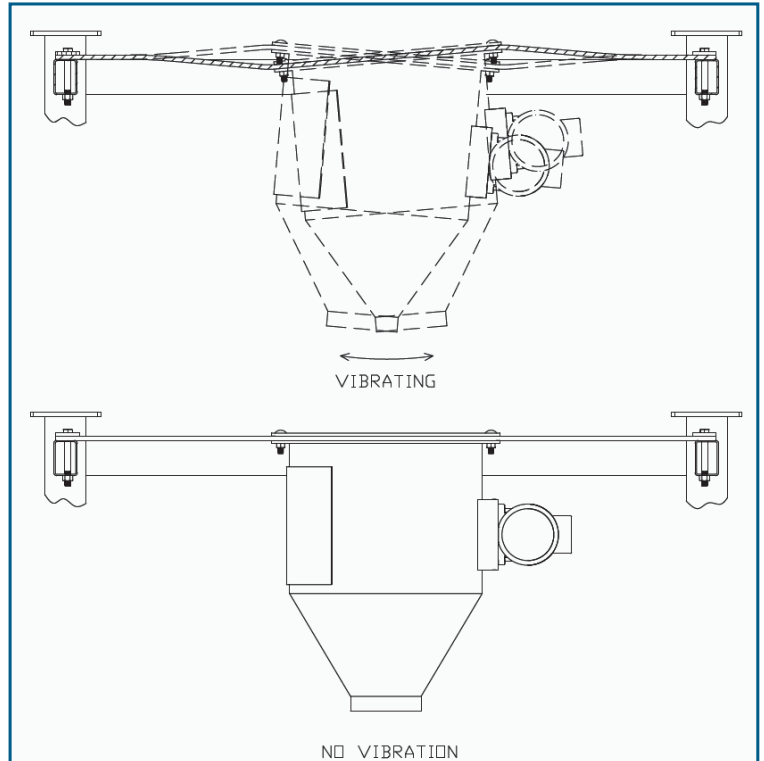
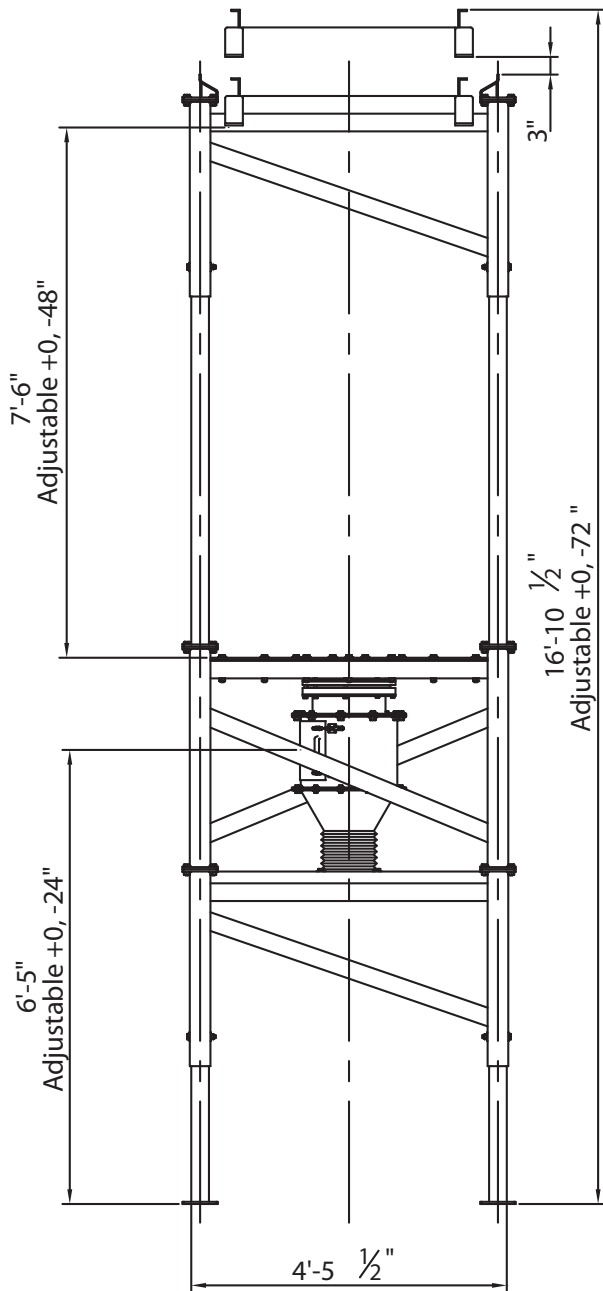

The vibrator and flexible membrane combination loosens bulk solids that may have compacted during storage or shipment.

Optional spout-lock system permits complete closing for bag tying and removal.



Process Capability and Requirements	
Frame Load Capacity	2 metric tons
Bag Size Capacity	Up to 74"H x 48"W x 54"D
Electric Vibrator	1/6 hp, 120 V
Dust Collection Port	1 1/2"
Air Requirements	2 SCFM @ 65 psi